

Washer Hose Loose

Service Category Vehicle Exterior

Section Wiper/Washer

Market USA

Toyota Supports
 ASE Certification 

Applicability

YEAR(S)	MODEL(S)	ADDITIONAL INFORMATION
2009 – 2010	Corolla	

Introduction

Some 2009 – 2010 Corolla vehicles may exhibit a rattle noise coming from the engine room area. The noise may be caused by the washer hose hitting the top of the engine valve cover. In some cases, no noise is heard, but the hose is found loose during routine service. An improved tape has been developed to correct this condition.

Production Change Information

This TSB applies to 2009 – 2010 vehicles produced **BEFORE** the Production Change Effective VINs shown below.

MODEL	PLANT	PRODUCTION CHANGE EFFECTIVE VIN
Corolla (NAP)	TMMC 11th digit = C	2T1BU4EE#AC196991
	NUMMI 11th digit = Z	1NXBU4EE#AZ174901
Corolla (CBU)	Takaoka 11th digit = J	JTDBU4EE#AJ057487
	Kanto 11th digit = 9	JTDBU4EE#A9100197

Warranty Information

OP CODE	DESCRIPTION	TIME	OFF	T1	T2
BD9056	Replace wiper hose tape	0.3	90068-33068	62	57

APPLICABLE WARRANTY

- This repair is covered under the Toyota Comprehensive Warranty. This warranty is in effect for 36 months or 36,000 miles, whichever occurs first, from the vehicle's in-service date.
- Warranty application is limited to occurrence of the specified condition described in this bulletin.

Washer Hose Loose

Parts Information

PREVIOUS PART NUMBER	CURRENT PART NUMBER	PART NAME	QTY*
N/A	85372-02040	Protector, Washer Hose	1 Roll

* One roll is 20 meters (66 ft) in length and will provide enough material to repair multiple vehicles.

Repair Procedure

1. Remove the red tape holding the windshield washer hose to the hood clip, as shown in Figure 1.
 - A. Remove the clip from the hood.
 - B. Remove the tape by cutting.

Figure 1.

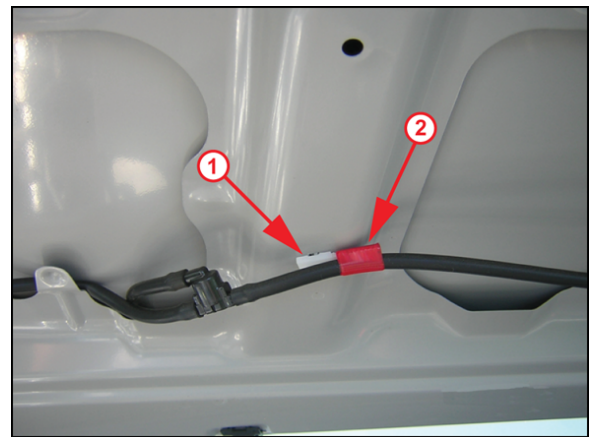

1	Hood Clip
2	Red Tape

2. Cut the tape into 3 separate pieces to the following dimensions:
 - Length: 90 mm (3 5/8 in.)**
 - Width: 19 mm (3/4 in.)**

Figure 2.

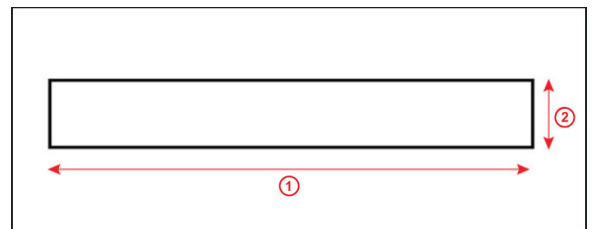

1	90 mm (3 5/8 in.)
2	19 mm (3/4 in.)

Washer Hose Loose

Repair Procedure (Continued)

3. Reattach the washer hose to the clip by wrapping it a minimum of 3 turns using NEW tape.

Perform this repair in the 3 locations shown in Figure 3.

Figure 3.

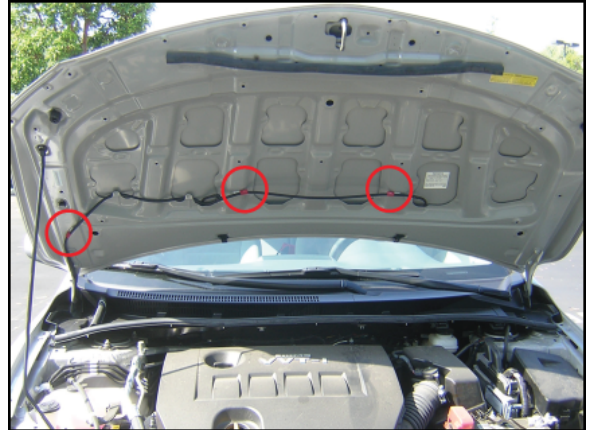

4. Reinstall the clips to the hood.