

Instrument Panel Rattle Noise

Service Category Vehicle Interior

Section Interior Panels/Trim

Market USA

Toyota Supports
 ASE Certification 

Applicability

YEAR(S)	MODEL(S)	ADDITIONAL INFORMATION
2009	Corolla, Matrix	

TSB REVISION NOTICE

February 25, 2009 Rev1:

- The VIN Information in the Production Change Information section has been updated.
- Repair Procedure: Matrix section has been updated to include an extra step.

Any previous printed versions of this service bulletin should be discarded.

Introduction

Some customers may experience a rattle noise coming from the instrument panel while driving in cold weather conditions on slightly rough roads. The following repair information has been provided to improve this condition.

Warranty Information

OP CODE	DESCRIPTION	TIME	OFF	T1	T2
NV8047	R & R Instrument panel subassembly & apply interior noise kit to dash pad (Corolla)	1.8	55302-#2###-##	91	57
	R & R Instrument panel subassembly & apply interior noise kit to dash pad (Matrix)	2.0	55302-022#0-B0		

APPLICABLE WARRANTY

- This repair is covered under the Toyota Comprehensive Warranty. This warranty is in effect for 36 months or 36,000 miles, whichever occurs first, from the vehicle's in-service date.
- Warranty application is limited to correction of a problem based upon a customer's specific complaint.

Instrument Panel Rattle Noise

Production Change Information

This TSB applies to vehicles produced **BEFORE** the Production Change Effective VINs shown below.

MODEL	PLANT	PRODUCTION CHANGE EFFECTIVE VIN
Corolla	TMMC	2T1BE40E#9C015111
	NUMMI	1NXBU40E#9Z095196
	Takaoka 11th digit = J	JTDBL40E#9J035079
	Kanto 11th digit = 9	JTDBL40E#99062874
Matrix	TMMC	2T1KE40E#9C015110
		2T1LE40E#9C006797
		2T1GE40E#9C003319
		2T1KU40E#9C040500

Parts Information

PREVIOUS PART NUMBER	CURRENT PART NUMBER	PART NAME	QTY
08231-00801	Same	Interior Noise Kit	1

Required Tools & Equipment

SPECIAL SERVICE TOOLS (SST'S)	PART NUMBER	QTY
Plastic Pry Tool Set*	00002-06000-01	1

* Essential SST.

NOTE
Additional SSTs may be ordered by calling SPX/OTC at 1-800-933-8335.

Confirmation Procedure

1. Confirm rattle noise from the dashboard by driving in cold weather on a slightly rough road.
 - A. If noise is confirmed from the forward area of the dash pad by the base of the windshield, then proceed to step 1 of the removal procedure.
 - B. If noise is heard from another location, this bulletin does NOT apply. Continue inspection to identify and repair other causes of noise.

Instrument Panel Rattle Noise

Removal Procedure

NOTICE

Some operations in this section may affect the SRS airbags. Prior to performing the corresponding operations, read the precautions regarding the SRS airbags.

1. Disconnect cable from negative (-) battery terminal.

CAUTION

Wait at least 90 seconds after disconnecting the cable from the negative (-) battery terminal to disable the SRS system.

2. Remove Dash Pad

For dash pad removal instructions, refer to the applicable model year repair manual, Technical Information System (TIS):

- 2009 model year Corolla:
Vehicle Interior – Interior Panels/Trim – Upper Instrument Panel: [Removal](#)
- 2009 model year Matrix:
Vehicle Interior – Interior Panels/Trim – Upper Instrument Panel: [Removal](#)

Repair Procedure: Corolla

1. From the interior noise kit use the 0.5 mm felt and cut 3 sections to the following dimensions.

Figure 1.

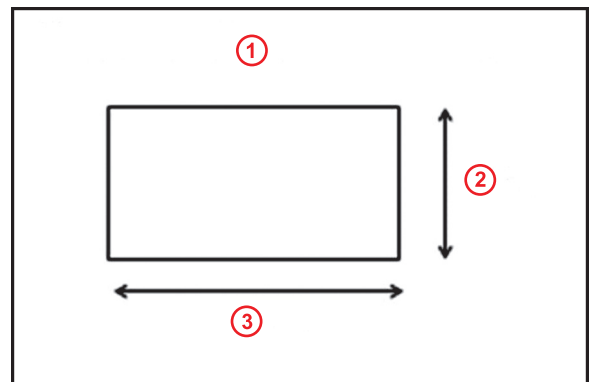

1	35 mm X 60 mm; t: 0.5 mm
2	35 (L)
3	60 (W)

Instrument Panel Rattle Noise

Repair Procedure: Corolla (Continued)

2. Apply the cut felt section to the Dashboard clips that contact the cowl panel (3 locations).

Figure 2.

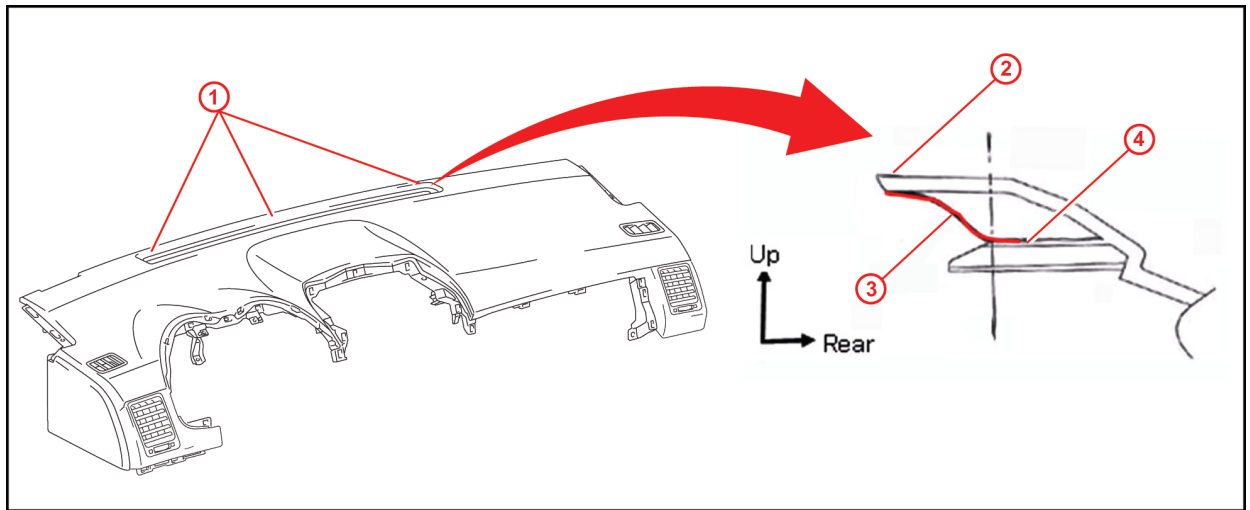

1	Contact Points
2	Exterior Surface of Dashboard
3	Felt
4	Inserted Completely

Figure 3 shows the correct felt application to the dashboard clips (dashboard is upside down to show felt condition).

3. After felt application, it should resemble this condition (Dashboard is up-side-down for purpose of showing felt condition).

Figure 3.

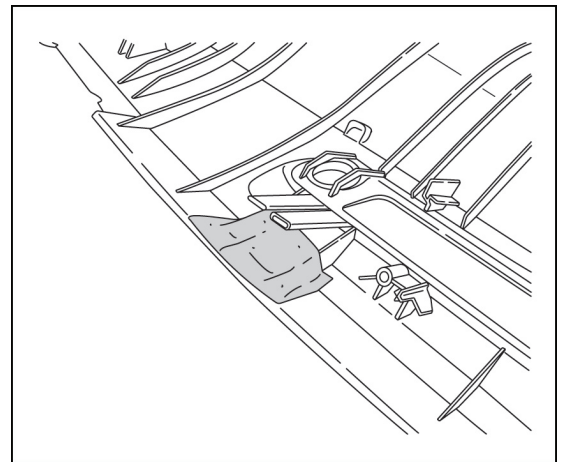

Instrument Panel Rattle Noise

Repair Procedure: Matrix

1. Add felt to the following locations at the contact points between the dashboard and cowl panel.

Figure 4.

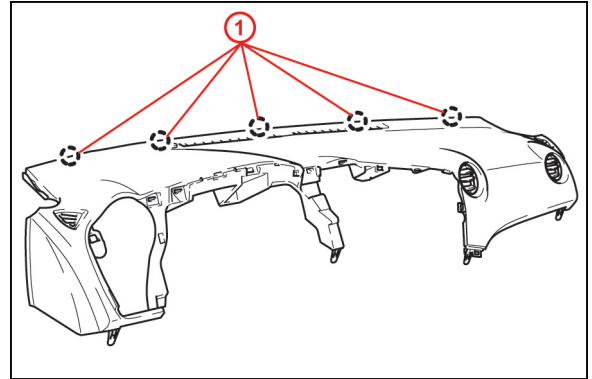

1	Clips
----------	--------------

2. For location points 1 and 5 use the following procedure:

- A. From the interior noise kit use the 0.5 mm felt and cut 2 sections to the following dimensions.

Figure 5.

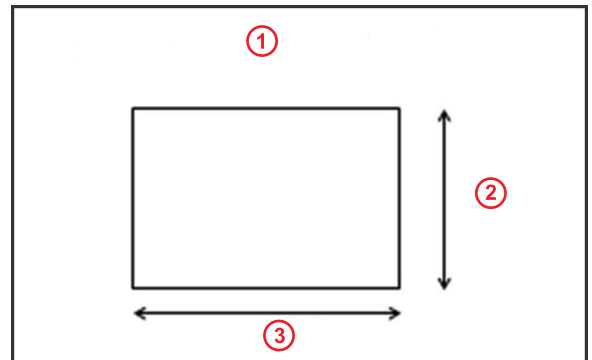

1	40 mm X 50 mm ; t:0.5 mm
2	40 (L)
3	50 (W)

Instrument Panel Rattle Noise

Repair Procedure: Matrix (Continued)

B. Apply the cut felt section to the Dashboard clips that contact the cowl panel (2 locations).

Figure 6.

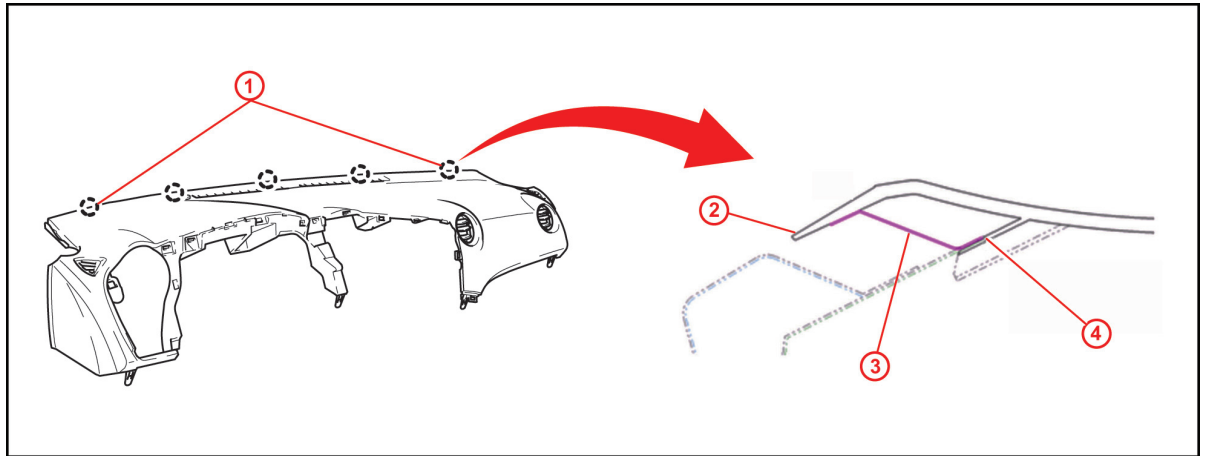

1	Contact Points
2	Exterior Surface of Dashboard
3	Felt
4	Inserted Completely

C. After felt application, it should resemble this condition (Dashboard is up-side-down for purpose of showing felt condition).

Figure 7.

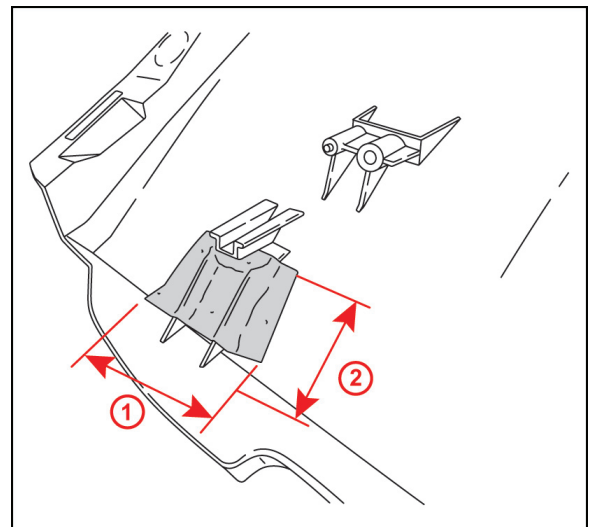

1	50 mm
2	40 mm

Instrument Panel Rattle Noise

Repair Procedure: Matrix (Continued)

3. For contact points 2 through 4 follow the following procedure:

A. From the interior noise kit use the 0.5mm felt and cut 3 sections to the following dimensions

Figure 8.

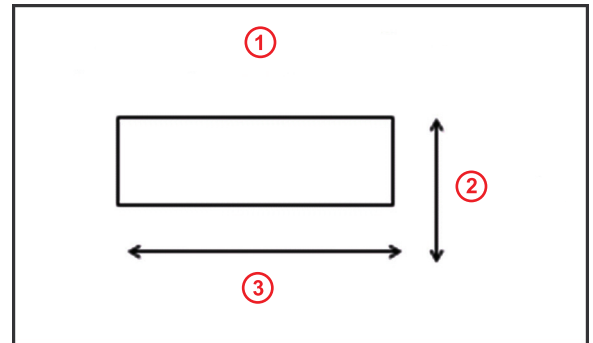

1	13 mm X 30 mm ; t: 0.5 mm
2	13 (W)
3	30 (L)

B. Apply the cut felt section to the Dashboard clips that contact the cowl panel (3 locations).

Figure 9.

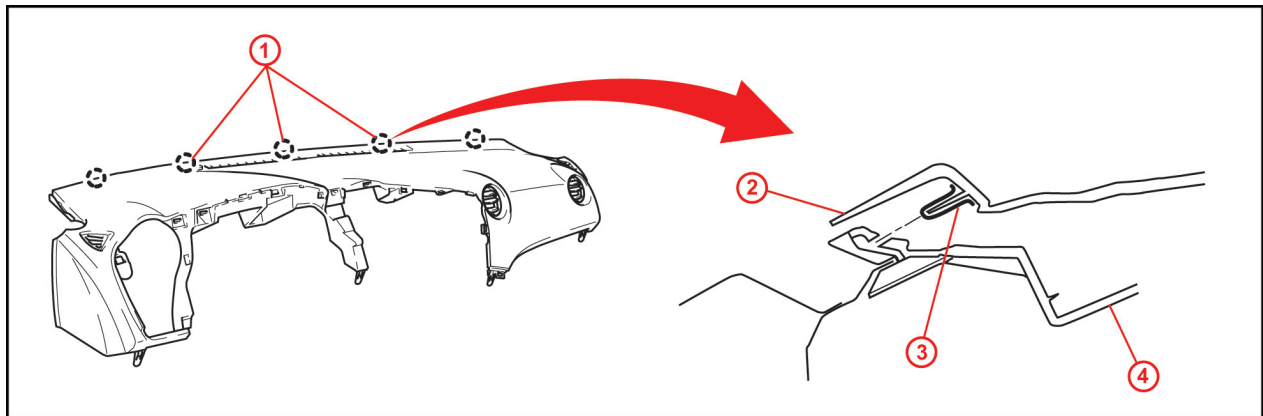

1	Clips
2	Upper Instrument Panel
3	Felt
4	Safety Pad

Instrument Panel Rattle Noise

Repair Procedure: Matrix (Continued)

- C. After felt application, it should resemble this condition (Dashboard is upside-down for purpose of showing felt condition).

Figure 10.

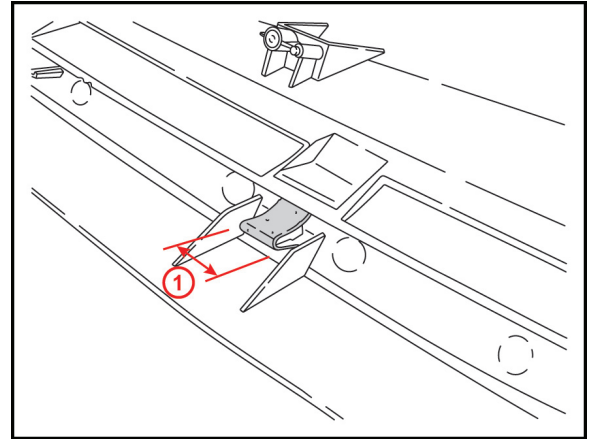

1	13 mm
---	-------

Installation Procedure

1. Install Upper Instrument Panel Sub-Assembly in the reverse order as removal.

For dash pad installation instructions, refer to the applicable model year repair manual, Technical Information System (TIS):

- 2009 model year Corolla:
Vehicle Interior – Interior Panels/Trim – Upper Instrument Panel: [Installation](#)
- 2009 model year Matrix:
Vehicle Interior – Interior Panels/Trim – Upper Instrument Panel: [Installation](#)

2. Connect battery and re-initialize sunroof, if equipped.
3. Test drive vehicle and confirm noise is eliminated.