



TECHNICAL SERVICE BULLETIN

REF.: ENGINE
 NO.: EN91-006
 DATE: MAY 24, 1991
 MODEL: MA/MX

FUEL LINE TORQUE SPECIFICATIONS

Page 1 of 2

The fuel line torque specifications on 7M-GE and 7M-STE engines have been revised as the gasket material has changed from copper-plated to tin-plated. Torques for union bolts and pulsation damper are different depending on the type of gasket used.

GASKET LOCATION	PREVIOUS – COPPER PLATED		NEW GASKET – TIN PLATED	
	P/N	TORQUE	P/N	TORQUE
#1 UPPER LOWER	90430-17002 90430-14002	29 ft-lb (31 N-m)	90430-17006 90430-14007	* 23 ft-lb (31 N-m)
#2 UPPER LOWER	90430-12005 "	22 ft-lb (29 N-m)	90430-12026 "	23 ft-lb (31 N-m)
#3 UPPER LOWER	90430-08005 "	13 ft-lb (18 N-m)	90430-08012 "	8 ft-lb (11 N-m)
#4 UPPER LOWER	90430-10204 "	18 ft-lb (25 N-m)	90430-10012 "	18 ft-lb (25 N-m)

Previous and new parts are interchangeable

* Torque must be 20 ft-lb (26 N-m) when the pulsation damper is installed.

COMPONENT LOCATION:

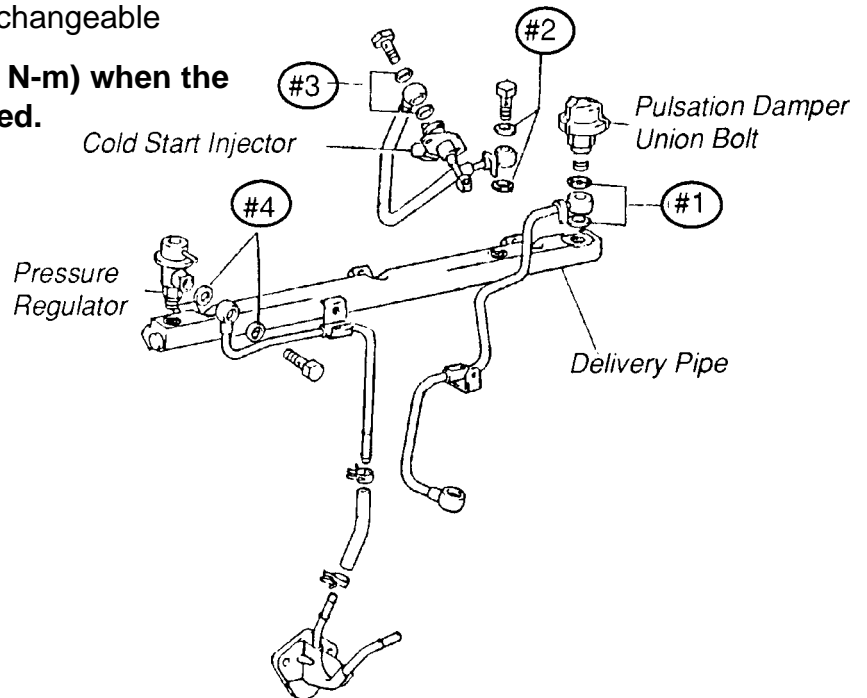

FUEL LINE TORQUE SPECIFICATIONS (CONT'D)

PRODUCTION EFFECTIVE:

From Production Date: July, 1990
From Engine No. 7M-0430925
From VIN: JT2MA70**L0152306
JT2MX83**L0061819
JT2MX83**L0062952
JT2MX83**L5007101
JT2MX83**L5007497

PART NUMBER INFORMATION:

The following new gasket kits and cold start injector assemblies include new tin-plated fuel line gaskets. The revised torque specifications apply whenever the tin-plated fuel line gasket is used.

PREVIOUS PART NO.	NEW PART NO.	DESCRIPTION
04111-42020	04111-42021	Engine Overhaul Gasket Kit
04111-42030	04111-42031	"
04112-42020	04112-42021	Engine Valve Grind Gasket Kit
04112-42030	04112-42031	"
23260-49105	23260-49126	Injector Assy. Cold Start Fuel
23260-49115	23260-49116	"
23260-49125	23260-49126	"