

Front License Plate & Bracket Installation

Service Category General

Section Pre-Delivery Service

Market USA

Toyota Supports
 ASE Certification 

Applicability

YEAR(S)	MODEL(S)	ADDITIONAL INFORMATION
2010	Matrix	

Introduction

The front license plate mounting bracket and 2 self-tapping screws for 2010 model year Matrix vehicles are loaded in the luggage compartment at the assembly plant. Follow the procedure below to install the front license plate and mounting bracket during Pre-Delivery Service (PDS).

Warranty Information

OP CODE	DESCRIPTION	TIME	OFP	T1	T2
N/A	Not Applicable to Warranty	–	–	–	–

Front License Plate & Bracket Installation

Installation Procedure

1. Insert the license plate into the front license plate mounting bracket.

Figure 1.

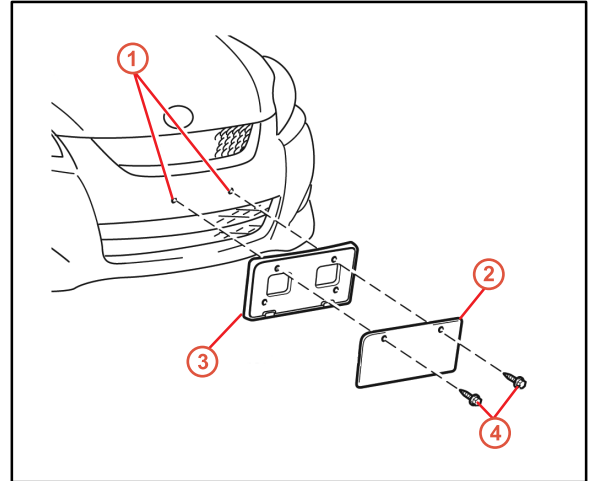

1	Dimples
2	License Plate
3	Front License Plate Mounting Bracket
4	Self-Tapping Screws

2. Align the installation holes on the front license plate mounting bracket and license plate with the dimples on the front bumper.
3. Screw the two self-tapping screws directly into the dimples to install the license plate and mounting bracket.

NOTE

- Do NOT pre-drill holes in the dimples.
- Do NOT over-tighten the self-tapping screws.