

# Front Brake Rattle Noise

Service  
Category Brake

Section Brake (front)

Market USA

Toyota Supports  
ASE Certification 

## Applicability

YEAR(S)	MODEL(S)	ADDITIONAL INFORMATION
2003 – 2008	Corolla, Matrix	

### TSB SUPERSESSION NOTICE

The information contained in this TSB supersedes TSB No. BR004-07.

- The Title has been changed from “Front Brake Squeak” to “Front Brake Rattle Noise”.
- Applicability has been updated to include 2008 model year Corolla and Matrix vehicles.
- Production Change Information has been updated with new VIN information.
- Parts Information has been updated.
- The Components illustration (Figure 1) has been updated.
- Step 1 in the Repair Procedure has been modified.

TSB No. BR004-07 is Obsolete and any printed versions should be discarded. Be sure to review the entire content of this service bulletin before proceeding.

## Introduction

Some customers may experience a front brake rattle type noise when the car is traveling over bumps. Updated front disc brake cylinder (caliper) mountings and disc brake pad support plates are available to eliminate this condition.

## Production Change Information

This TSB applies to vehicles produced **BEFORE** the Production Change Effective VINs shown below.

MODEL	DRIVETRAIN	PLANT	PRODUCTION CHANGE EFFECTIVE VIN
Corolla	1ZZ	NUMMI	1NXBR32E78Z020741
		TMMC	2T1BR32E58C912309
Matrix			

## Front Brake Rattle Noise

---

### Parts Information

PREVIOUS PART NUMBER	CURRENT PART NUMBER	PART NAME	QTY
47721-02141	Same	Mounting, Disc Brake Cylinder	2
47717-02051	04947-02130	Pad Support Plate Kit	1
08887-80609	Same	Disc Brake Caliper Grease (50 g tube)	1

### Warranty Information

OP CODE	DESCRIPTION	TIME	OFF	T1	T2
473301	Front Disc Brake Pad and/or Disc Brake Pad Shim (Both Sides)	0.8	47721-02140	91	13

#### **APPLICABLE WARRANTY**

- This repair is covered under the Toyota Comprehensive Warranty. This warranty is in effect for 36 months or 36,000 miles, whichever occurs first, from the vehicle's in-service date.
- Warranty application is limited to correction of a problem based upon a customer's specific complaint.

# Front Brake Rattle Noise

## Components

Figure 1. Front Disc Brake Components

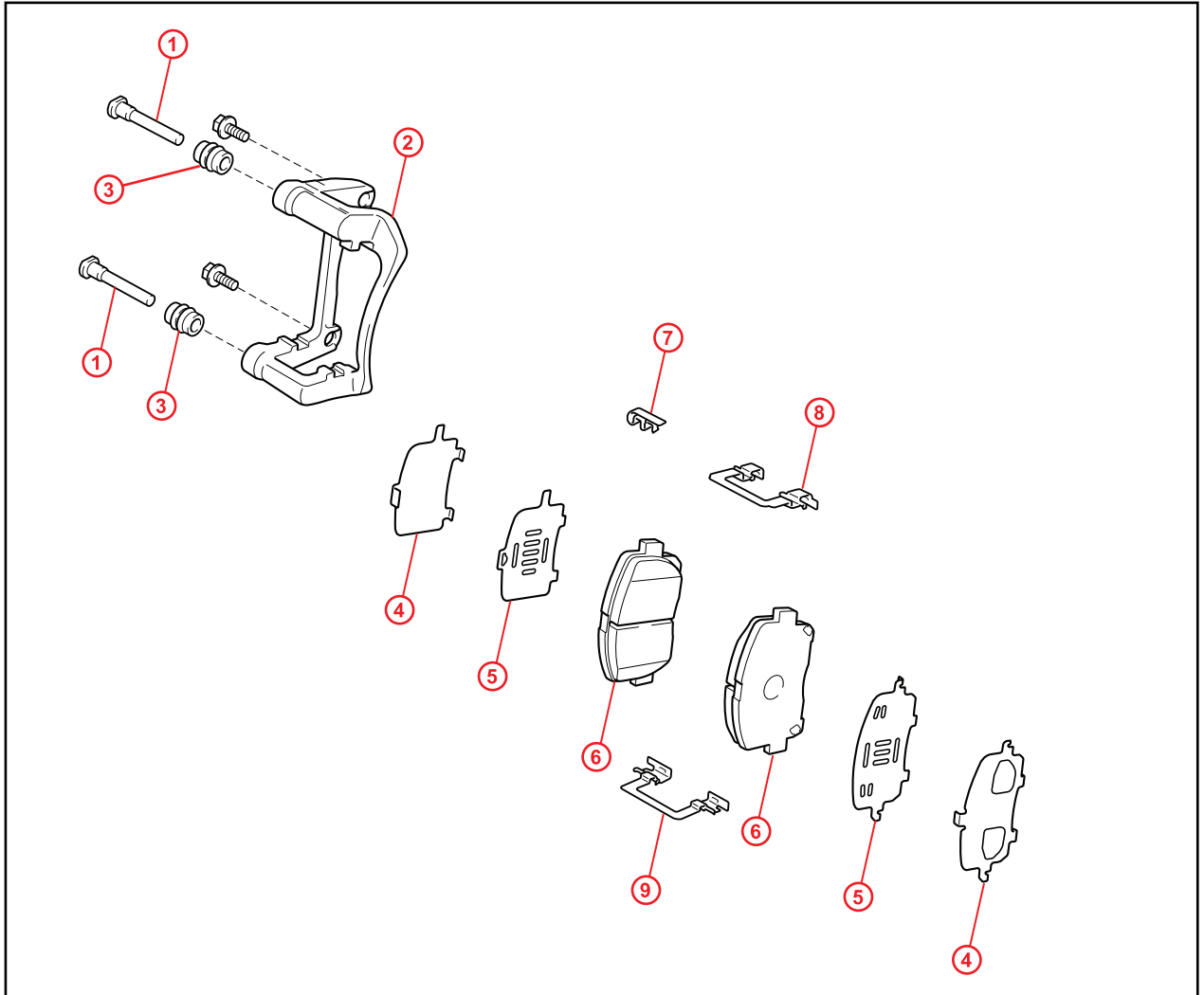

<b>1</b>	<b>Front Disc Brake Cylinder Slide Pin</b>
<b>2</b>	<b>Front Disc Brake Cylinder Mounting LH</b>
<b>3</b>	<b>Bush Dust Boot</b>
<b>4</b>	<b>Anti-Squeal Shim No. 2</b>
<b>5</b>	<b>Anti-Squeal Shim No. 1</b>

<b>6</b>	<b>Disc Brake Pad</b>
<b>7</b>	<b>Pad Wear Indicator Plate</b>
<b>8</b>	<b>Front Disc Brake Pad Support Plate No. 1</b>
<b>9</b>	<b>Front Disc Brake Pad Support Plate No. 2</b>

## Front Brake Rattle Noise

---

### Repair Procedure

1. Conduct a road test to verify the noise condition — front brake rattle noise will occur when the front tire runs over a depression in the road.
2. Remove and replace the front disc brake pad support plates (2 per each caliper).

**NOTE**

**The procedures listed below are for one side and should be used for both the RH and LH side.**

- A. Remove the front wheel.
- B. Remove the caliper by holding the front disc brake slide pin and removing the 2 bolts.
- C. Remove the 2 front brake pads from the front disc brake cylinder mounting.
- D. Remove the anti-squeal shims and the pad wear indicator plates from each pad.
- E. Remove the 2 front disc brake pad support plates from the cylinder mounting.
- F. Remove the front disc brake cylinder mounting by removing the 2 bolts.
- G. Install the NEW disc brake cylinder mounting with the 2 bolts.  
**Torque: 107 N\*m (1089 kgf\*cm, 79 ft\*lbf)**
- H. Install the 2 NEW disc brake pad support plates.

Apply disc brake grease to the back of the brake pad support plate.

## Front Brake Rattle Noise

### Repair Procedure (Continued)

- I. Install the front anti-squeal shims.
  - (1) Apply disc brake grease to the anti-squeal shims.

**NOTE**

- When replacing worn pads, the anti-squeal shims **MUST** be replaced together with the pads.
- Make sure to install the shims in the correct positions and directions.
- Apply a thin layer of disc brake grease to the area that contacts the anti-squeal shim.
- Disc brake grease can come out slightly from the area where the anti-squeal shim is installed. Be sure to wipe off any excessive grease to avoid pad contamination.
- Make sure that disc brake grease is **NOT** applied onto the lining surface.

**Figure 2. Front Disc Brake Grease Application**

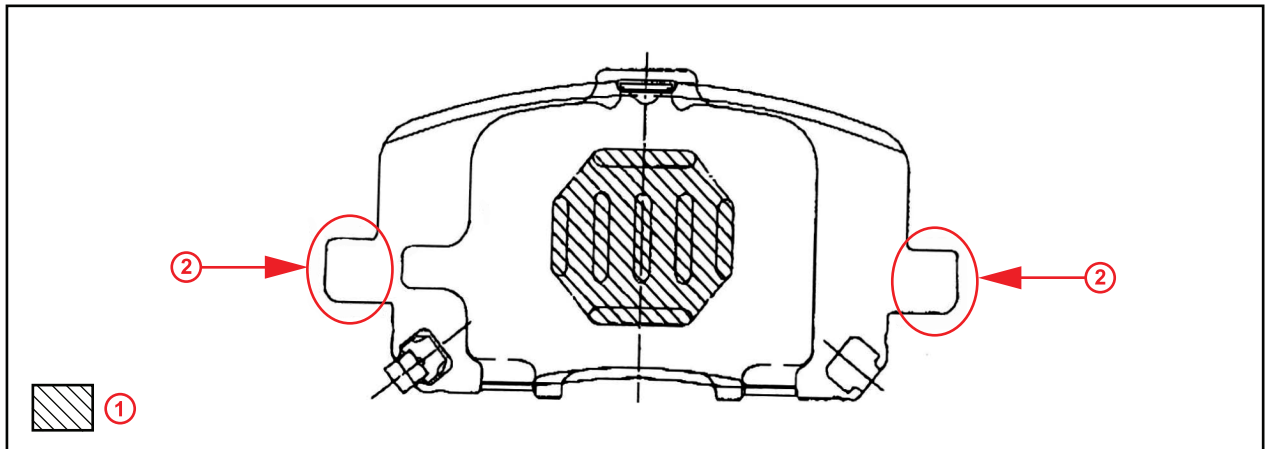

<b>1</b>	Area for Disc Brake Grease Application
<b>2</b>	Also Apply Disc Brake Grease Here (1 – 2 mm [0.04 – 0.08 in.])

- (2) Install the anti-squeal shims and the pad wear indicators to each pad.

**NOTE**

**Make sure to install the pad wear indicators in the correct positions and directions.**

## Front Brake Rattle Noise

---

### Repair Procedure (Continued)

- J. Install the 2 front brake pads with anti-squeal shims to the disc brake cylinder mounting.

Apply a small amount of the disc brake grease (1 – 2 mm [0.04 – 0.08 in.] thick) to the areas shown in Figure 2.

**NOTE**

**Do NOT apply grease to the friction surfaces of the brake pads or the disc rotor.**

- K. Install the caliper with the 2 bolts.

**Torque: 34 N\*m (350 kgf\*cm, 25 ft\*lbf)**

- L. Install the front wheel.

**Torque: 103 N\*m (1050 kgf\*cm, 76 ft\*lbf)**

3. Road test the vehicle to confirm the front brake rattle noise is NO longer present.