

# Floor Mat Retaining Clip Installation During PDS

Service  
Category General

Section Pre-Delivery Service

Market USA

Toyota Supports  
ASE Certification 

## Applicability

YEAR(S)	MODEL(S)	ADDITIONAL INFORMATION
2009	FJ Cruiser	

### TSB REVISION NOTICE

February 12, 2009 Rev1:

- This bulletin has been modified to include the floor mat installation procedure when retaining clips are installed at the factory.

Any previous printed versions of this service bulletin should be discarded.

## Introduction

The 2009 model year FJ Cruiser vehicles are equipped with 4 floor mat retaining clips to ensure that floor mats stay in the correct position. Attach the driver and passenger side floor mats to the vehicle carpet using the floor mat retaining clips during Pre-Delivery Service (PDS).

### CAUTION

- Make sure that both driver and passenger floor mats are properly placed on the vehicle carpet and secured with the 4 locking clips. If the driver's side floor mat slips and interferes with the movement of the pedals during driving, it may cause an accident.
- **NEVER** install more than one floor mat at a time in the driver's seating position.
- **ONLY** use floor mats that can be retained using the retaining clips. All OEM Toyota floor mats are specifically designed to fit correctly and be retained using the retaining clips.
- Verify the operation of the accelerator, brake, and clutch (if equipped) pedals and clearance to the mat.
- If applicable, any secondary set of floor mats (based upon customer preference, such as the all weather floor mats or other floor mats) **MUST** be placed in the trunk with all the packaging material intact. Do **NOT** install the secondary mat on top of the primary floor mat already installed in the driver's seating position.

## Floor Mat Retaining Clip Installation During PDS

### Introduction (Continued)

**NOTE**

Some vehicles may not have clips installed from the factory. Follow the procedure for Clip Installation before placing floor mats in vehicle.

### Warranty Information

OP CODE	DESCRIPTION	TIME	OFF	T1	T2
N/A	Not Applicable to Warranty	—	—	—	—

### Floor mat Installation Procedure

**NOTE**

Perform this procedure if the floor mat retaining clips were installed at the factory.

1. Attach the floor mat to the vehicle carpet using the clips. Secure the mat by inserting the retaining clips through the grommet holes.

Figure 1. Correct Installation



Figure 2. Incorrect Installation

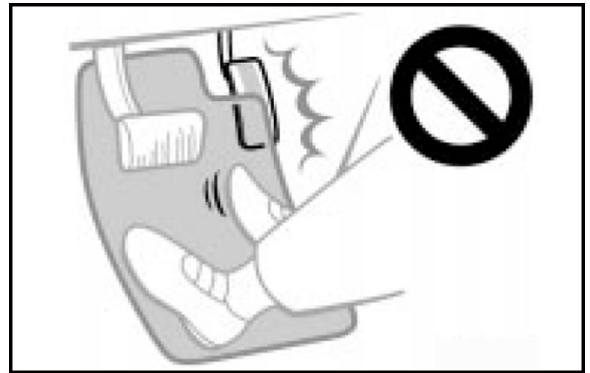

**NOTE**

If applicable, DO NOT remove the beige “Caution” tag from floor mat. Tag should be removed by customer only.

Figure 3.



## Floor Mat Retaining Clip Installation During PDS

---

### Clip Installation Procedure.

**NOTE**

Perform this procedure if floor mat retaining clips were not installed at the factory.

1. Remove the outer floor mat retaining clips from the glove box.
2. Using a small flat-tip screwdriver, pry the retaining clip flap up. **Figure 4.**

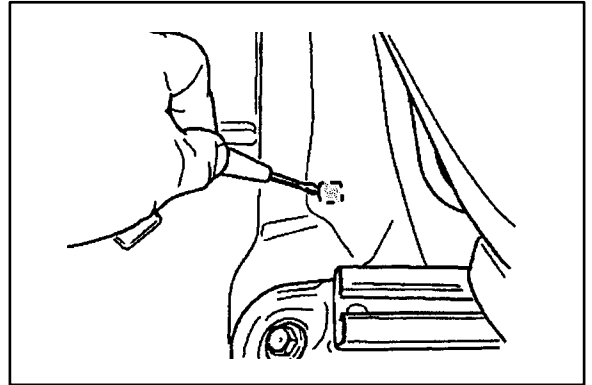

3. Using a utility knife, remove the retaining clip flap. **Figure 5.**

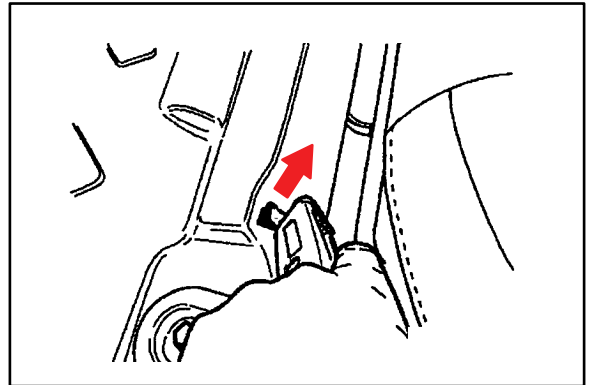

## Floor Mat Retaining Clip Installation During PDS

---

### Clip Installation Procedure. (Continued)

4. Insert the floor mat retaining clip insert nut into the mounting hole.

**Figure 6.**

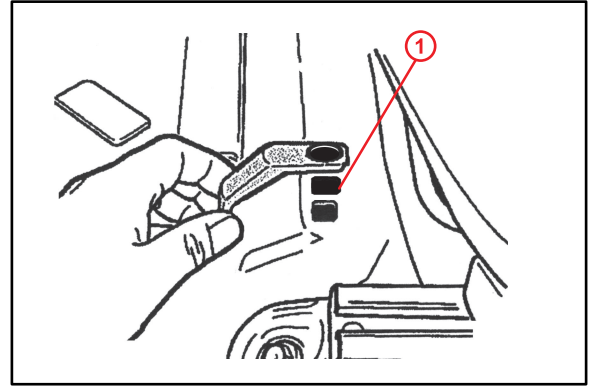

<b>1</b>	<b>Floor Mat Retaining Clip Insert Nut</b>
----------	--

5. Using a screwdriver, secure the floor mat retaining clip in place with the provided screw.

**Figure 7.**

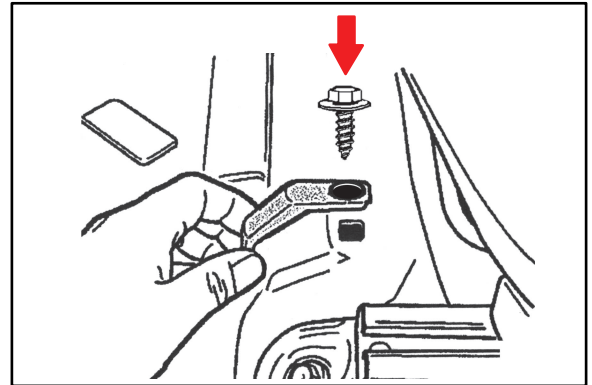

6. Follow the same procedure for the other side.

**NOTE**

If the floor mat retaining clips are **NOT** installed, the floor mats can move while driving and when passengers get in and out of the vehicle.