

Difficulty Closing Glove Box

Service Category Vehicle Interior

Section Interior Panels/Trim

Market USA

Toyota Supports
 ASE Certification 

Applicability

YEAR(S)	MODEL(S)	ADDITIONAL INFORMATION
2009	Matrix	

Introduction

Some 2009 model year Matrix vehicles may exhibit a condition where the latch on the LEFT side of the glove box will not properly engage the instrument panel causing the glove box door to fall open and making it difficult to close. The following repair procedure has been developed to correct this condition.

Warranty Information

OP CODE	DESCRIPTION	TIME	OFF	T1	T2
BD9051	Shim Lower Instrument Panel	0.3	55550-02240-B0	9A	13

APPLICABLE WARRANTY

- This repair is covered under the Toyota Comprehensive Warranty. This warranty is in effect for 36 months or 36,000 miles, whichever occurs first, from the vehicle's in-service date.
- Warranty application is limited to occurrence of the specified condition described in this bulletin.

Required Tools & Equipment

SPECIAL SERVICE TOOLS (SST'S)	PART NUMBER	QTY
Plastic Pry Tool Set*	00002-06000-01	1

* Essential SST.

NOTE

Additional SSTs may be ordered by calling 1-800-933-8335.

Difficulty Closing Glove Box

Required Materials

MATERIAL	QTY
4 mm (5/32 in.) thick washer	1

Repair Procedure

1. Confirm the latch on the LEFT side of the glove box door is not contacting the instrument panel correctly.
2. Verify proper latch operation.

NOTE
If the glove box latch does NOT operate correctly, STOP. This TSB DOES NOT apply.

3. Remove the glove box door.
 - A. Disengage the claw and release the glove box door stopper.
 - B. Open the glove box door past the stops in the direction indicated by the arrows in the illustration. Release the 2 stoppers and lower the glove box door until the glove box door is parallel to the floor.

Figure 1.

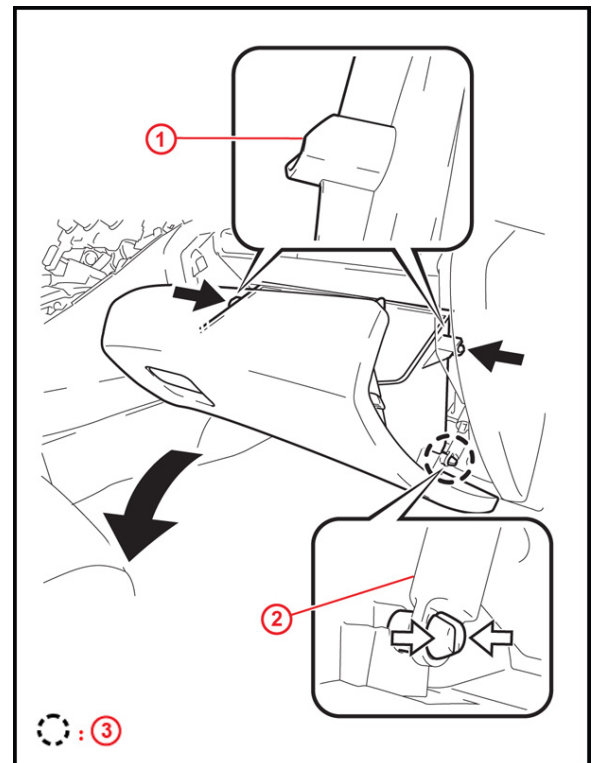

1	Stopper
2	Glove Compartment Door Stopper
3	Claw

Difficulty Closing Glove Box

Repair Procedure (Continued)

- C. Pull the glove box door horizontally toward the rear of the vehicle to release the 2 hinges, and remove the glove box door.

NOTICE

Pulling the glove box door upward to remove it causes the hinges to deform. Be sure to pull out the glove box door horizontally.

Figure 2.

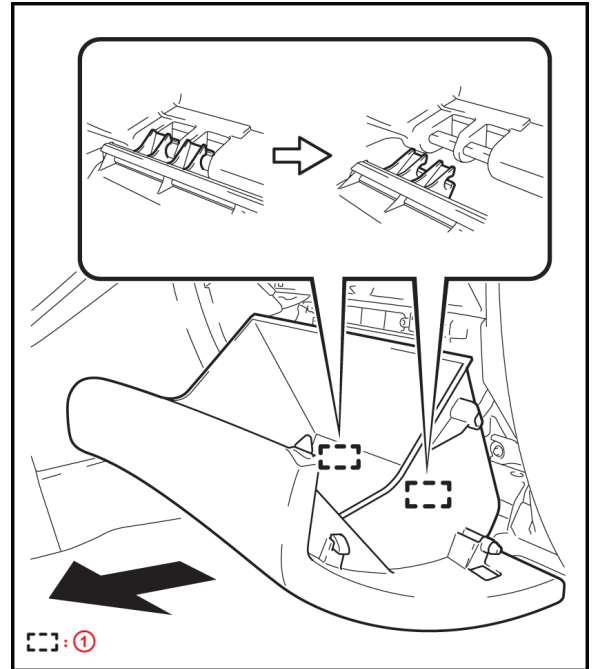

1	Hinge
---	-------

- 4. Disengage the 8 claws and remove the RF door scuff plate.

Figure 3.

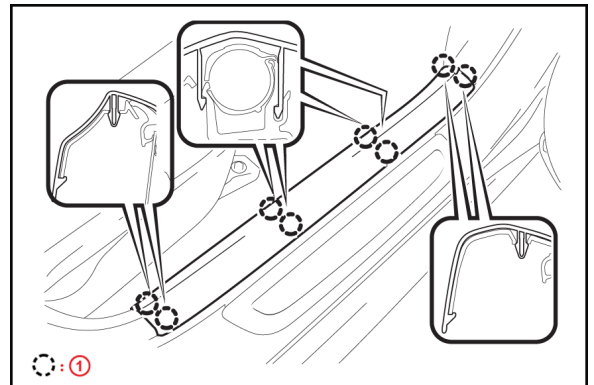

1	Claw
---	------

Difficulty Closing Glove Box

Repair Procedure (Continued)

5. Disengage the clip and claw, and remove the RF cowl side trim board.

Figure 4.

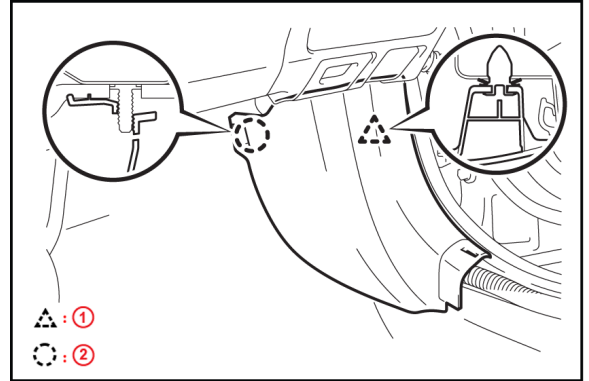

1	Clip
2	Claw

6. Remove the lower RIGHT instrument panel bolt.

Figure 5.



Difficulty Closing Glove Box

Repair Procedure (Continued)

7. Gently pull back the lower RIGHT side of the lower instrument panel and insert a 4 mm (5/32 in.) thick washer between the lower instrument panel and the body of the vehicle as shown in Figure 6.

Figure 6.

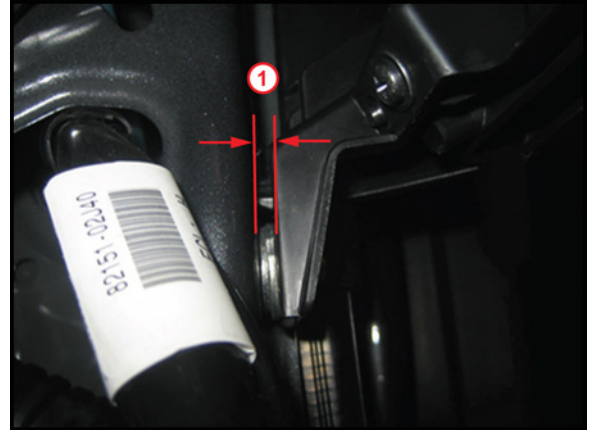

1	4 mm (5/32 in.) Washer
----------	-------------------------------

8. Reinstall the lower instrument panel bolt with the 4 mm (5/32 in.) washer in the center.
9. Reinstall the RF cowl side trim board, RF door scuff plate and the glove box door.
10. Verify that the latch on the LEFT side of the glove box door properly latches into the instrument panel and that the glove box door remains closed.